

# East Campus Streetscapes Phase 1 - Sequencing Plan Area A

Estimated Dates  
6/16/23-9/13/23

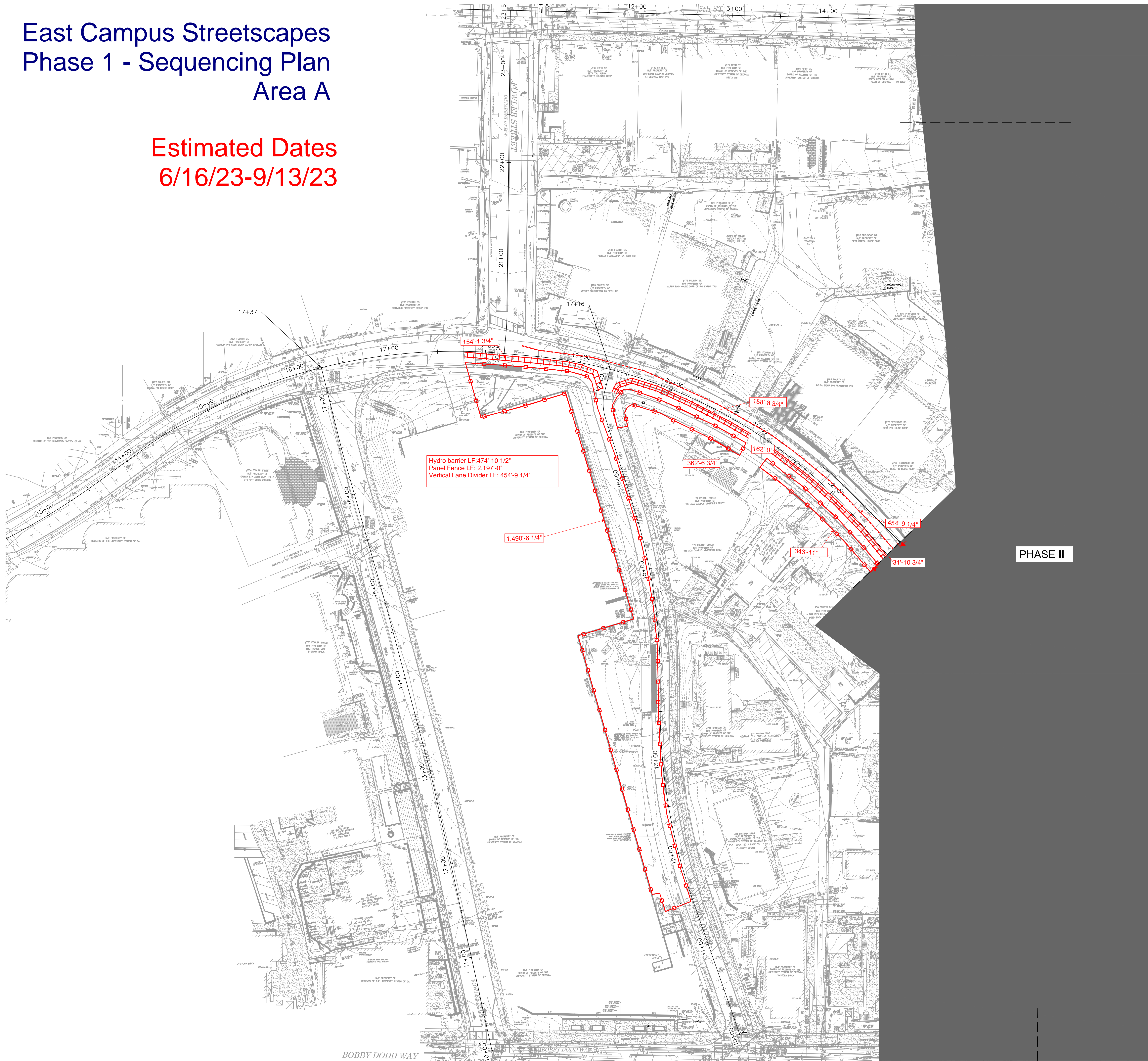

- 6' Panel Fence with Black Windscreen
- Hydrobarriers
- Vertical Lane Divider

FOR CONSTRUCTION

OVERALL KEY MAP  
THE GEORGIA INSTITUTE OF TECHNOLOGY  
EAST CAMPUS STREETSCAPES PHASE I - BR-30-2205  
ATLANTA, GEORGIA 30332

USER:SAWILSON  
FILE:F:\38890\38890\BR30-2205\BR30-2205-01\1-CAL\_DEMO-PLAN.dwg  
SAVED: 6/16/2023  
PLOT: 6/16/2023

**811** Know what's below  
Call before you dig.  
811  
www.call811.com

PERMIT NUMBERS: SWGR# 2019058350 CAC# 2019058605 SWGR# 2019068953 CAC# 2019015332	
PARCEL ID: 10404017300	FEMA PANEL: ZONE "X" PANEL NO. 4703702643H, 48517
DATUM: TNSPC (NAD83) NAVD 1988	BENCHMARK: TAG BOLT ON HYDRANT # 15722, ELEV. 522.30'
SCALE: 1 INCH = 40 FEET	

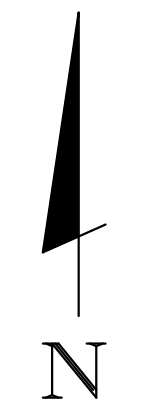

REV.	DATE	CHK.	DESCRIPTION



# East Campus Streetscapes Phase 1 - Sequencing Plan Area B

Estimated Dates  
7/25/23-10/23/23

**BARGE**  
DESIGN SOLUTIONS  
OVERLOOK II  
2839 PACES FERRY ROAD SE  
SUITE 850  
ATLANTA, GEORGIA 30339  
770.628.7631  
BARGEDESIGN.COM

**TOOLE**  
DESIGN

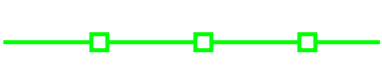
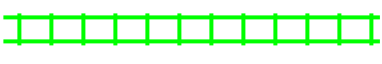
NEWCOMB  
& BOYD

-  6' Panel Fence with Black Windscreen
-  Hydrobarriers
-  Vertical Lane Divider

FOR CONSTRUCTION



PHASE II

USER:SAWILSON  
FILE:F:\38096\38096\804\_CADD\PLT\PHASE1\38096\_001-CAL\_DEMO-PLAN.dwg  
SAVED: 4/25/2023  
PLOT: 4/25/2023

OVERALL KEY MAP

THE GEORGIA INSTITUTE OF TECHNOLOGY  
EAST CAMPUS STREETSCAPES PHASE I - BR-30-2205  
ATLANTA, GEORGIA 30332

**811** Know what's below  
Call before you dig.  
811  
www.call811.com

PERMIT NUMBERS: SWGR# 2019050350 CAC# 2019058605 SWGR# 2019068953 CAC# 2019015332	PARCEL ID: 10404017300 FEMA PANEL: ZONE "X" PANEL NO. 470370245H, 48517
DATUM: TNSPC (NAD83) NAVD 1988	BENCHMARK: TAG BOLT ON HYDRANT # 15722. ELEV. 522.30'

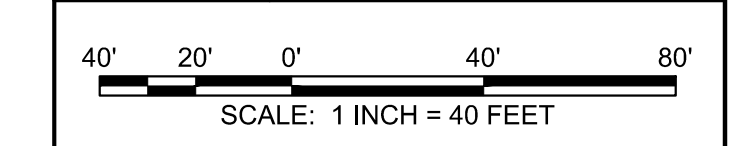
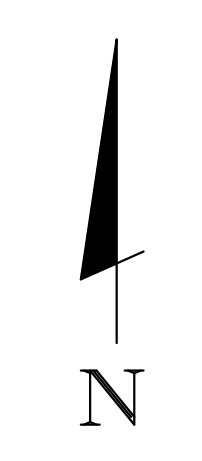

# East Campus Streetscapes Phase 1 - Sequencing Plan Area C-1

Estimated Dates  
9/25/23-10/23/23

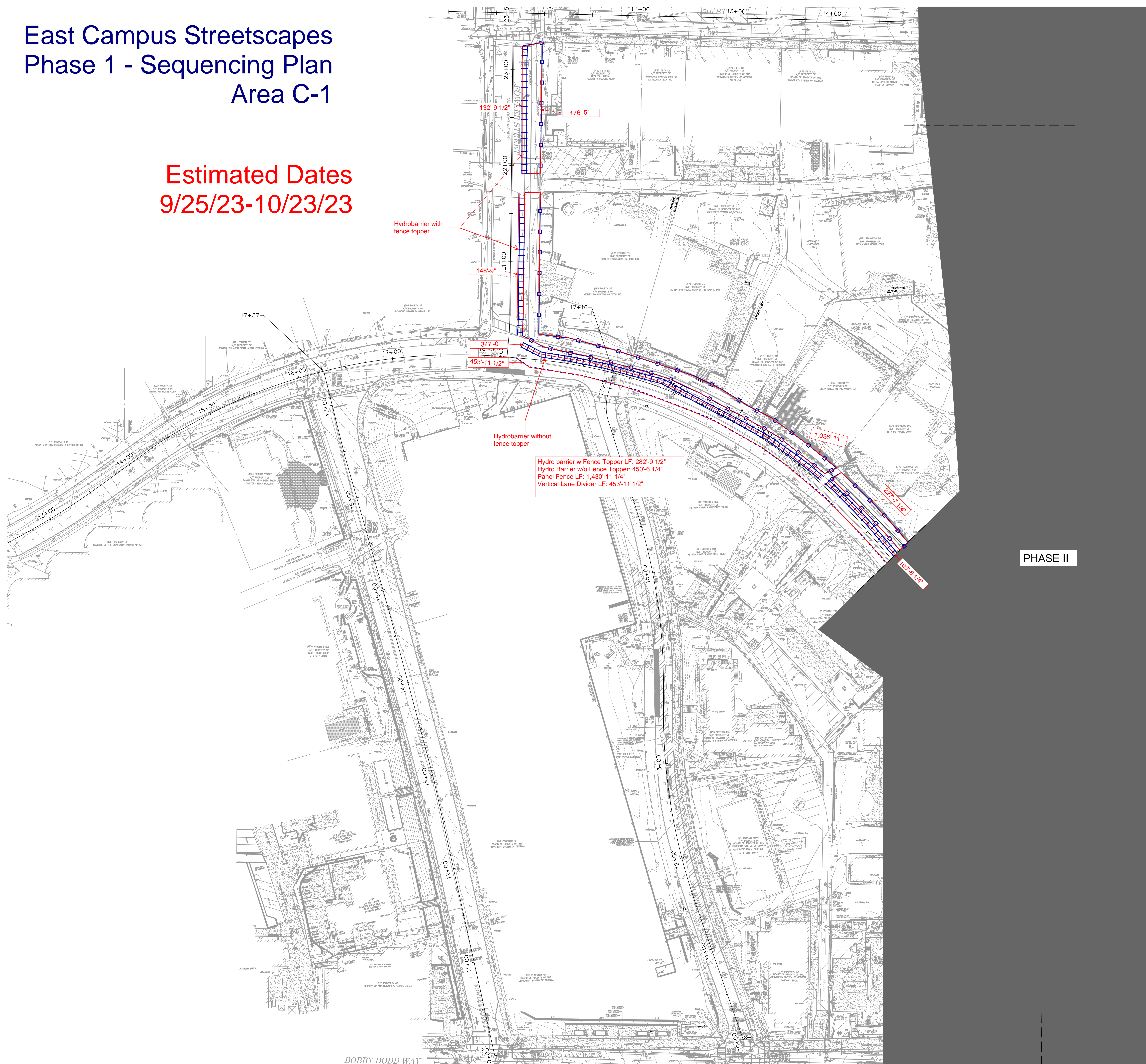

- 6' Panel Fence with Black Windscreen
- Hydrobarriers
- Vertical Lane Divider

Hydro barrier w Fence Topper LF: 282'-9 1/2"  
Hydro Barrier w/o Fence Topper: 450'-6 1/4"  
Panel Fence LF: 1,430'-11 1/4"  
Vertical Lane Divider LF: 453'-11 1/2"

PHASE II

FOR CONSTRUCTION

OVERALL KEY MAP

THE GEORGIA INSTITUTE OF TECHNOLOGY  
EAST CAMPUS STREETSCAPES PHASE I - BR-30-2205  
ATLANTA, GEORGIA 30332

USER:SAWILSON  
FILE:U:\38090904\_CAD\CIVIL\LOT\Phase 1\38090904\_CAD\CAD\_DEMO-PLAN.dwg  
SAVED: 4/25/2023  
PLOT: 4/25/2023

**811** Know what's below  
Call before you dig.  
811  
www.call811.com

PERMIT NUMBERS: SWGR# 2019050350 CAC# 2019058605 SWGR# 2019068953 CAC# 2019015332	PARCEL ID: 10404017300 FEMA PANEL: ZONE "X" PANEL NO. 470370243H_46517
DATUM: TNSPC (NAD83) NAVD 1988	BENCHMARK: TAG BOLT ON HYDRANT # 15722. ELEV. 522.30'

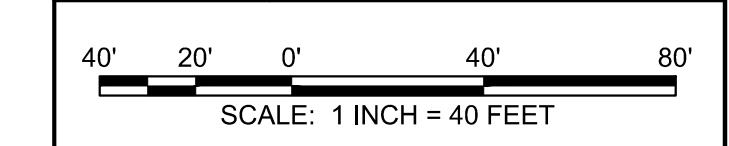
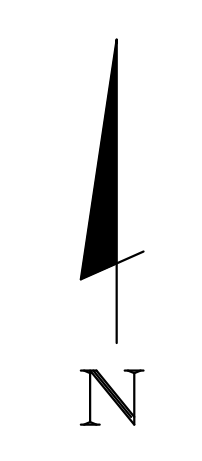

REV.	DATE	CHK.	BY	DESCRIPTION

# East Campus Streetscapes Phase 1 - Sequencing Plan Area C-2

Estimated Dates  
10/25/23-12/6/23



- 6' Panel Fence with Black Windscreen
- Hydrobarriers
- Vertical Lane Divider

PHASE II

PERMIT NUMBERS:  
 SWGR# 2019050350 CAC# 2019058605  
 SWGR# 2019068953 CAC# 2019015332

PARCEL ID: 10404017300 FEMA PANEL: # 4703702643H\_46517

DATUM: TNSPC (NAD83) NAVD 1988 BENCHMARK: TAG BOLT ON HYDRANT # 15722. ELEV. 522.30'

SCALE: 1 INCH = 40 FEET

**BARGE**  
DESIGN SOLUTIONS  
OVERLOOK II  
2839 PACES FERRY ROAD SE  
SUITE 650  
ATLANTA, GEORGIA 30339  
770.628.7631  
BARGEDSIGN.COM

**TOOLE**  
DESIGN

NEWCOMB  
& BOYD **NB**

FOR CONSTRUCTION

OVERALL KEY MAP



THE GEORGIA INSTITUTE OF TECHNOLOGY  
EAST CAMPUS STREETSCAPES PHASE I - BR-30-2205  
ATLANTA, GEORGIA 30332

USER:SAWLSON  
 FILE:U:\38090698\BR30\_2205\CAD\CIVIL\LOT\Phase 1\BR30-2205\_C011-CAL\_DEMO-PLAN.dwg  
 SAVED:4/25/2023  
 PLOTTED:4/25/2023

# East Campus Streetscapes Phase 1 - Sequencing Plan Area D-1

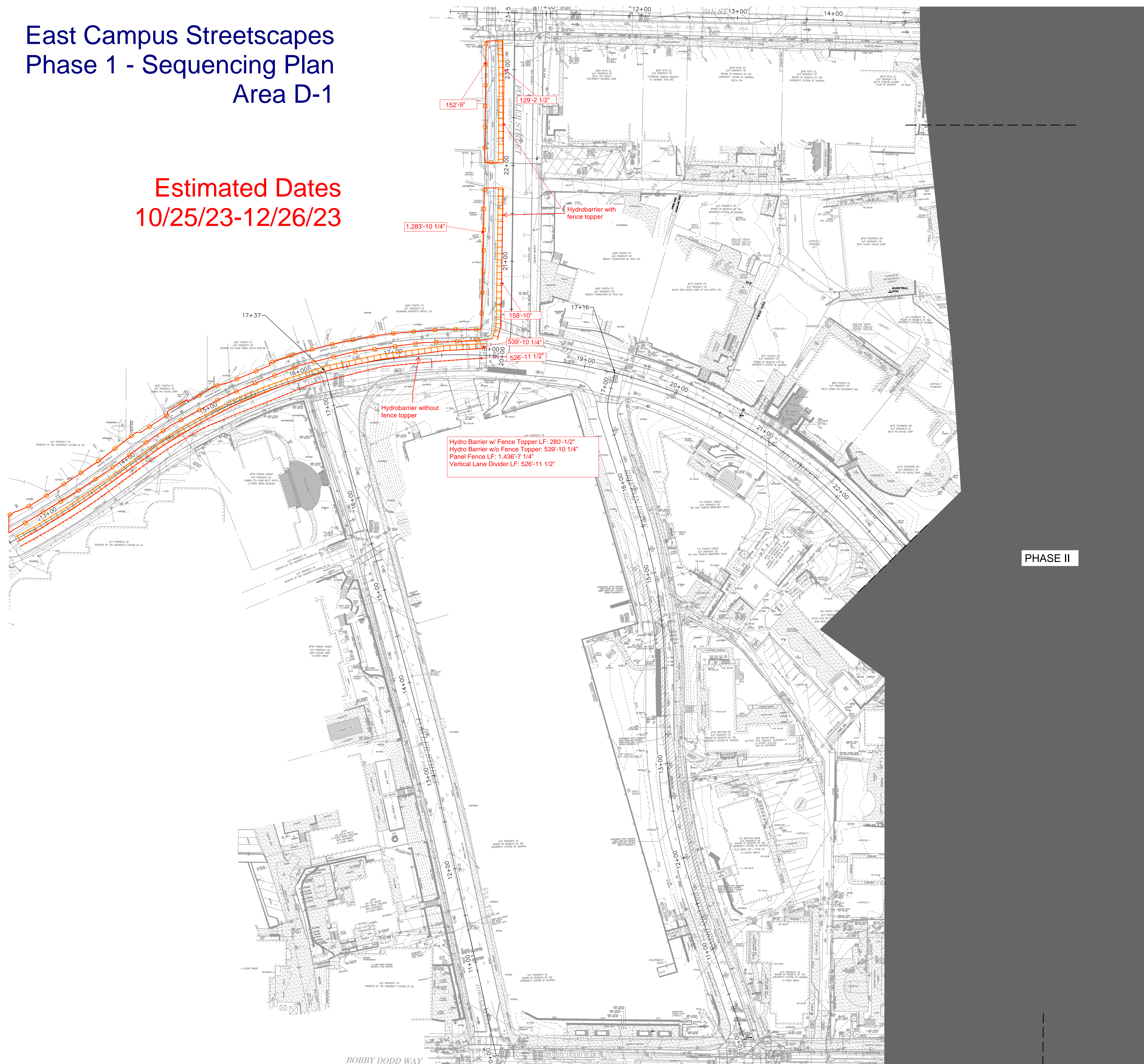
Estimated Dates  
10/25/23-12/26/23



-  6' Panel Fence with Black Windscreen
-  Hydrobarriers
-  Vertical Lane Divider

FOR CONSTRUCTION

OVERALL KEY MAP

THE GEORGIA INSTITUTE OF TECHNOLOGY  
EAST CAMPUS STREETSCAPES PHASE I - BR-30-2205  
ATLANTA, GEORGIA 30332

**811** Know what's below  
Call before you dig.  
811  
www.call811.com

PERMIT NUMBERS:  
SWGR# 2019050350 CAC# 2019058605  
SWGR# 2019068953 CAC# 2019015332

PARCEL ID: 10404017300 FEMA PANEL: ZONE "X" PANEL NO. 4703702434, 48517

DATUM: TNSPC (NAD83) BENCHMARK: TAG BOLT ON HYDRANT # 15722. ELEV. 522.30'  
NAVD 1988

SCALE: 1 INCH = 40 FEET

